

TOSHIBA

Toshiba Energy Systems & Solutions Corporation

Advanced reactors of Toshiba can be used to balance supply and demand in the electricity market

Next Generation BWR : iB1350

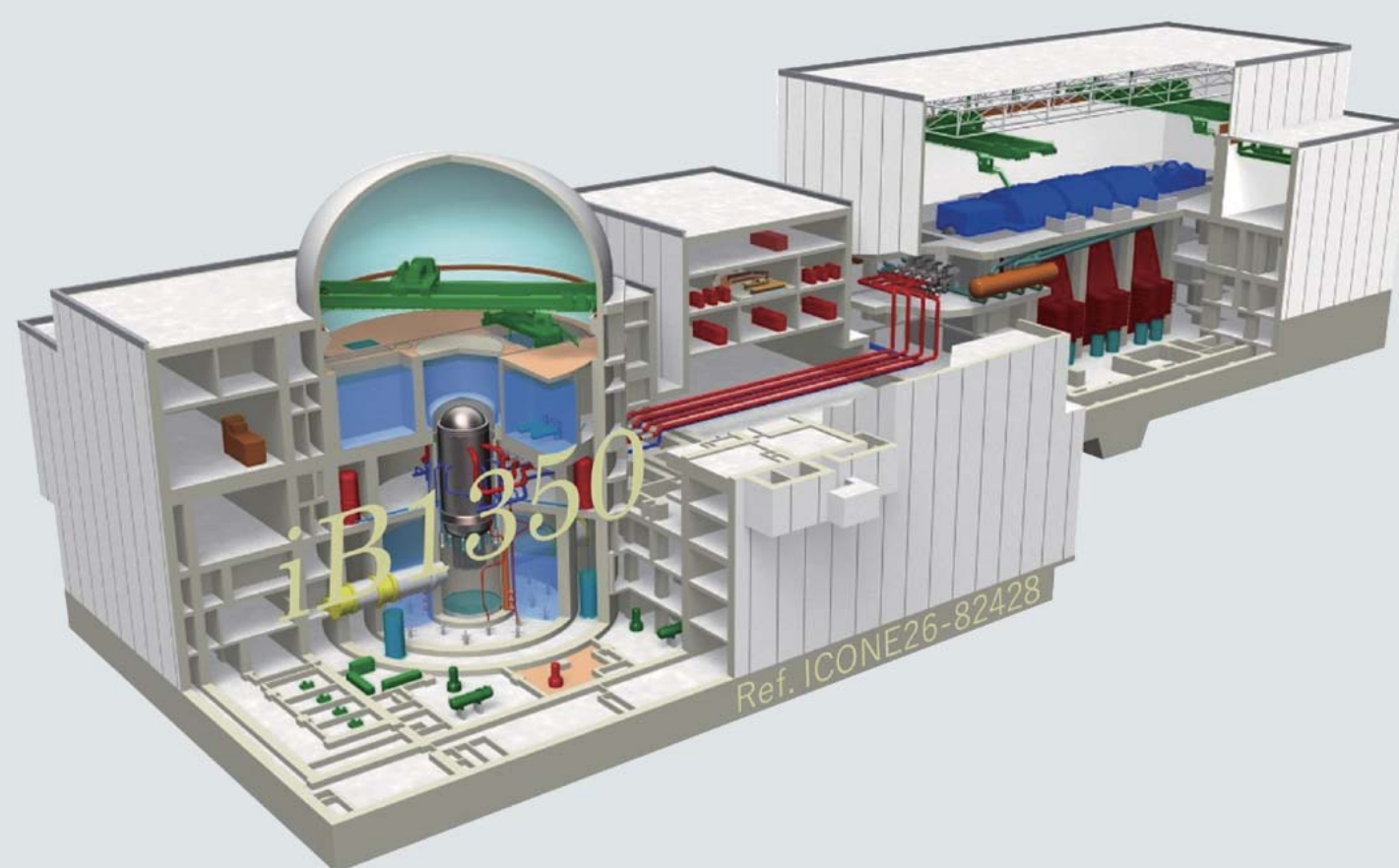

Electric output : **1,350MWe**

Providing large capacity power inexpensively and safely based on the proven ABWR

High Temperature Gas Reactor

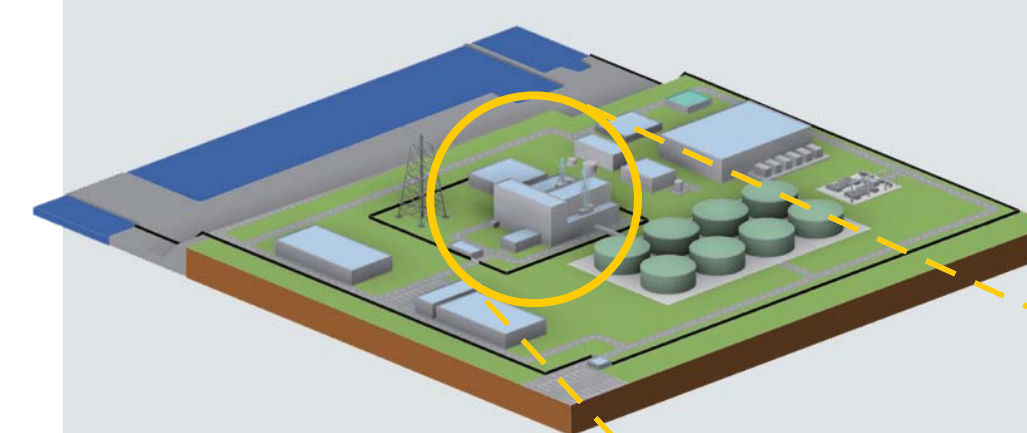

Electric output :
250~1,260MWe
(four reactor modules)

Reactor outlet temperature 750°C

Electric output :
250MWe/600MWt
(at a module)

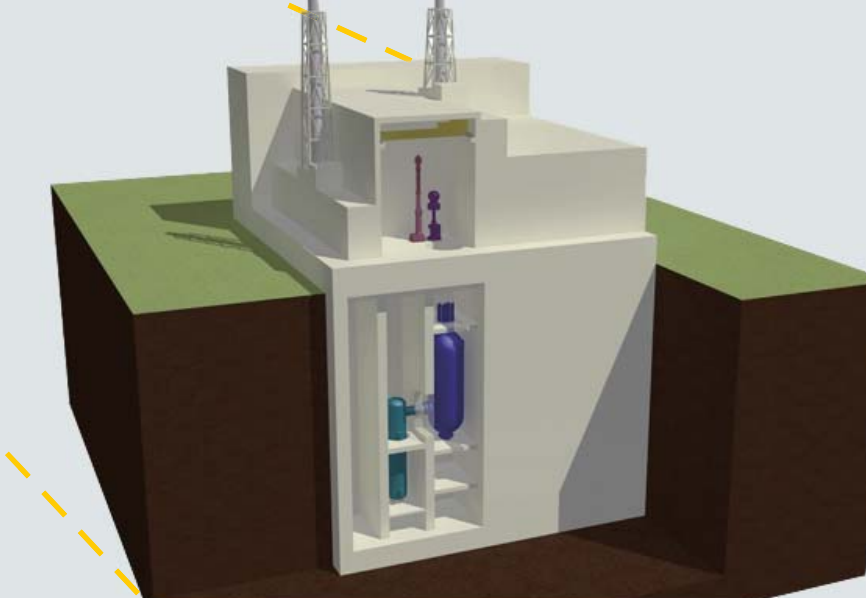

Coexistence with renewable energy due to flexible response by heat storage system

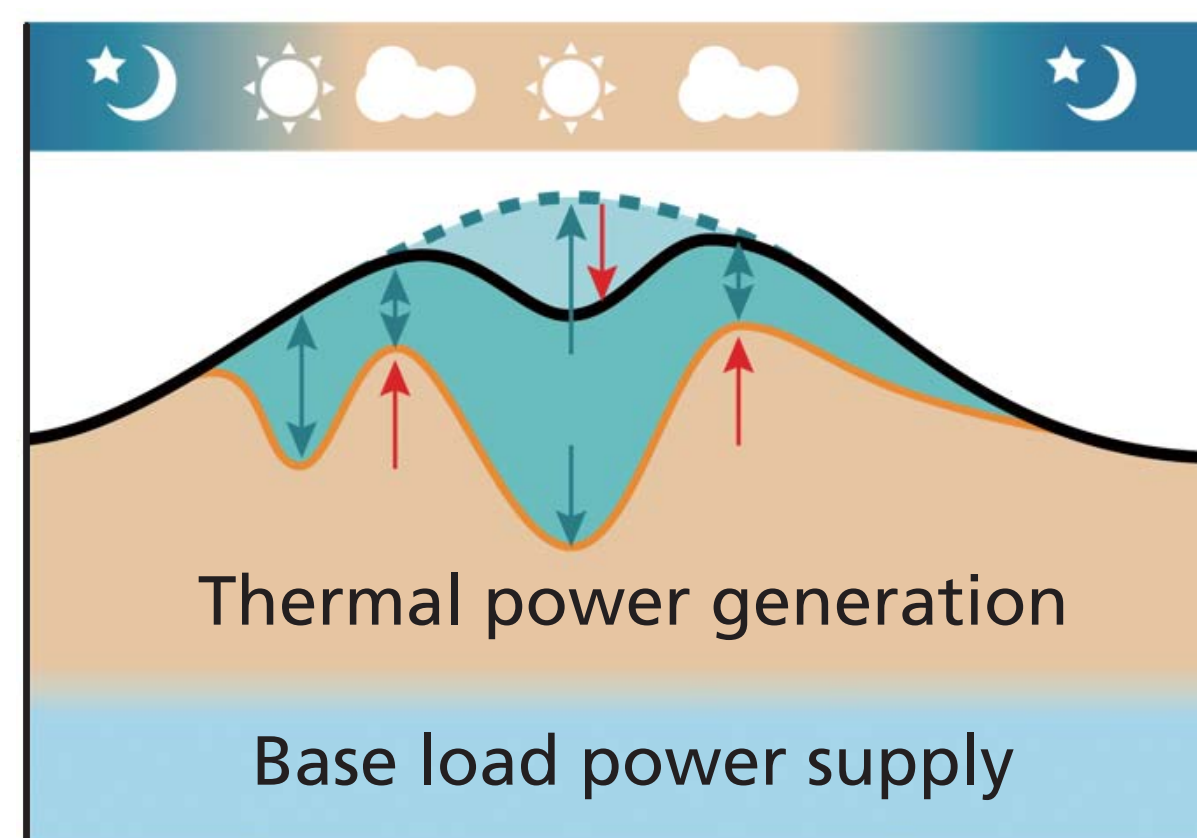

Image of power supply and demand

Reference : <https://www.enecho.meti.go.jp/about/special/tokushu/saiene/keitouseiyaku.html>

Scan for details ▶

