

HITACHI



New Technologies in Hitachi-GE Nuclear Energy

Development of 3 reactors; BWRX-300, PRISM and RBWR under Japan's NEXIP * initiative.

 LUMADA - Hitachi's digital technology supports the safe and stable operation of nuclear power plants.

*NEXIP : Nuclear Energy × Innovation Promotion

Advanced Reactors: BWRX-300, HI-ABWR and PRISM

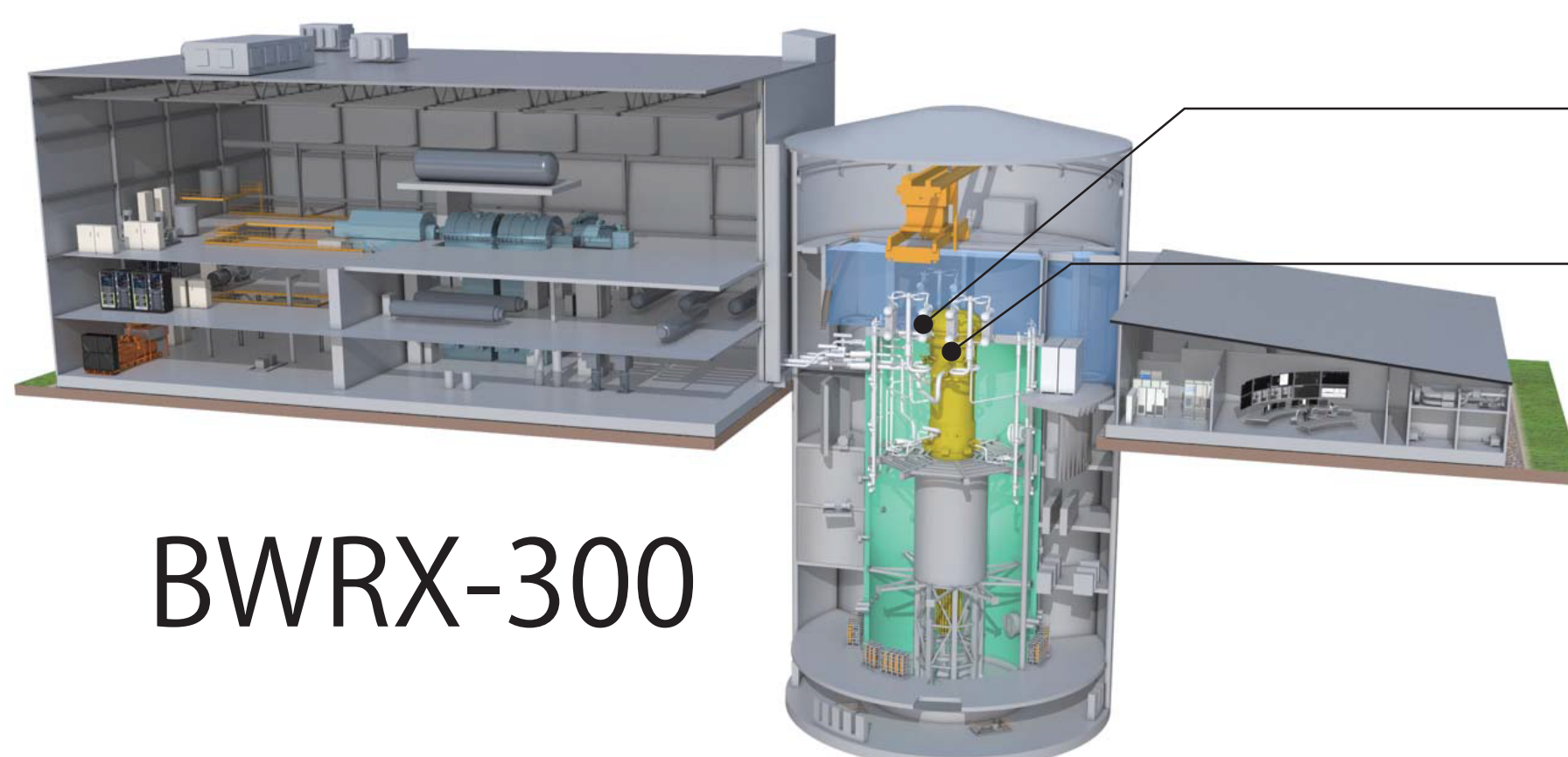

BWRX-300

Isolation valve integrated into the reactor vessel

Passive safety systems

Improved safety and security against external hazards

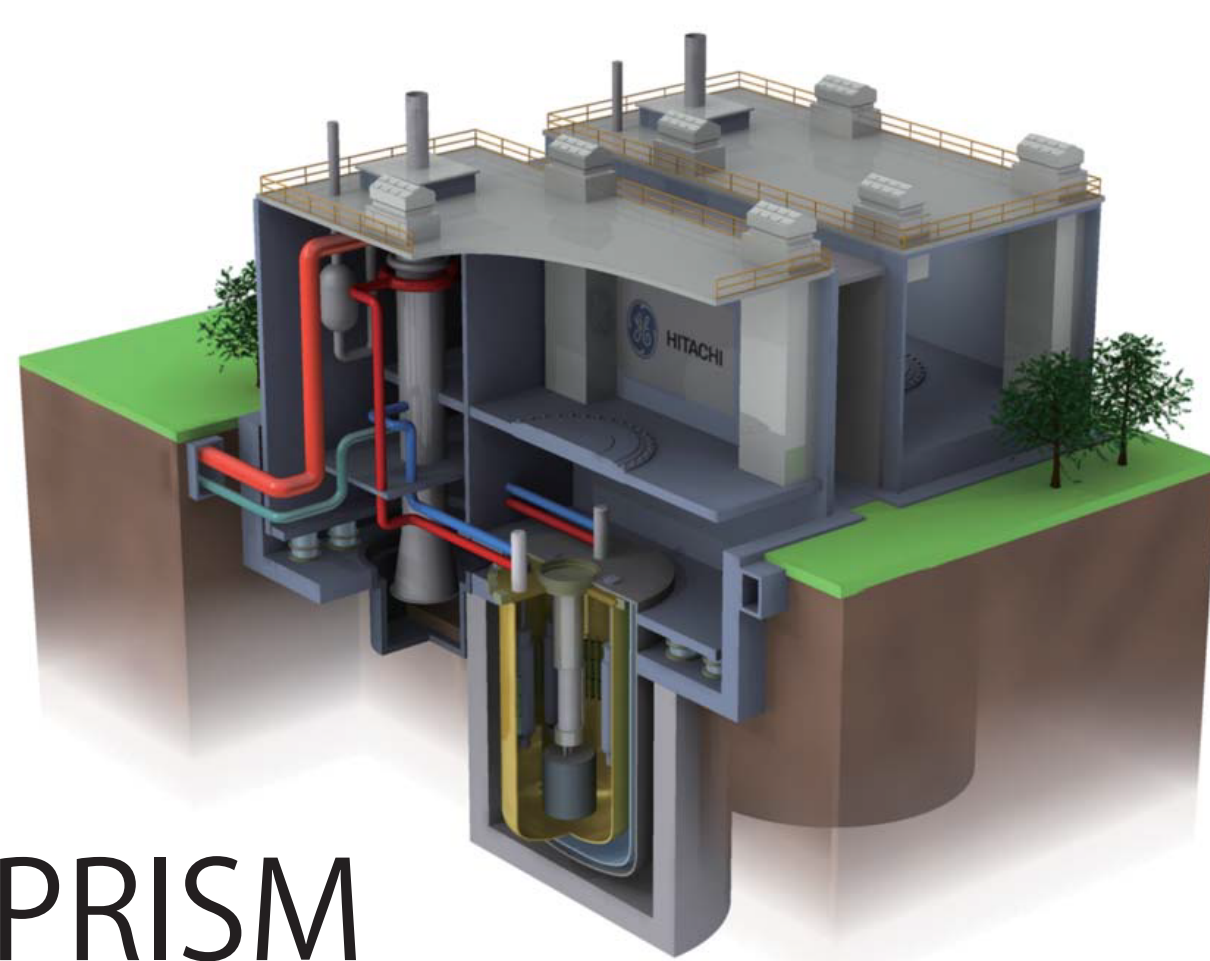

PRISM

Working with TerraPower to realize
 by combining PRISM
and molten salt storage system

Reinforced building
against airplane crashes

Passive safety system

Separation barrier

Core catcher
+ Lower drywell flooders

Noble gas filter

HI-ABWR
Highly Innovative ABWR

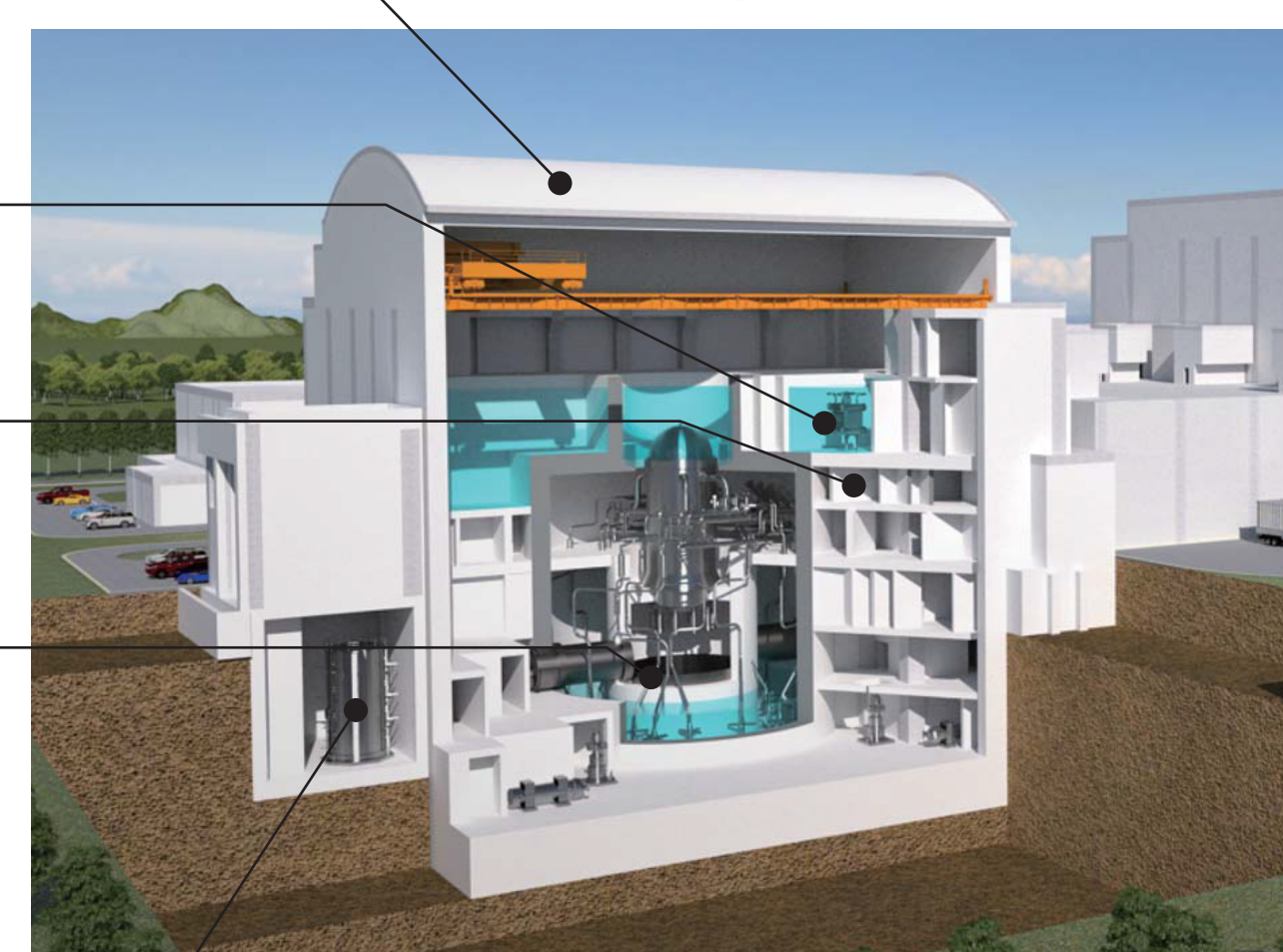

Scan the following
QR code for
more information